

PROJECT DATE	DRAWN BY	NO.	DATE	REVISION	BY
	JLS	-	-	-	-
	JLS	-	-	-	-
	JRH	-	-	-	-



ENGINEERING | ARCHITECTURE | SURVEYING
 FUNDING | PLANNING | ENVIRONMENTAL
 400 Ice Harbor Drive, Dubuque IA 52001
 (563) 582-3973 www.msa-ps.com
 © MSA International Services, Inc.

BALL FIELDS AND ROADWAY
 CITY OF WASHINGTON
 WASHINGTON, IOWA

OVERALL SITE PLAN

PROJECT NO.
 10322002
 SHEET
 51

PLOT DATE: Friday, March 6, 2020 11:00:47 AM P:\10322002\10322002\CADD\Construction Drawings\07th Street & E Avenue\GITE PLAN - BASEBALL FIELDS.dwg

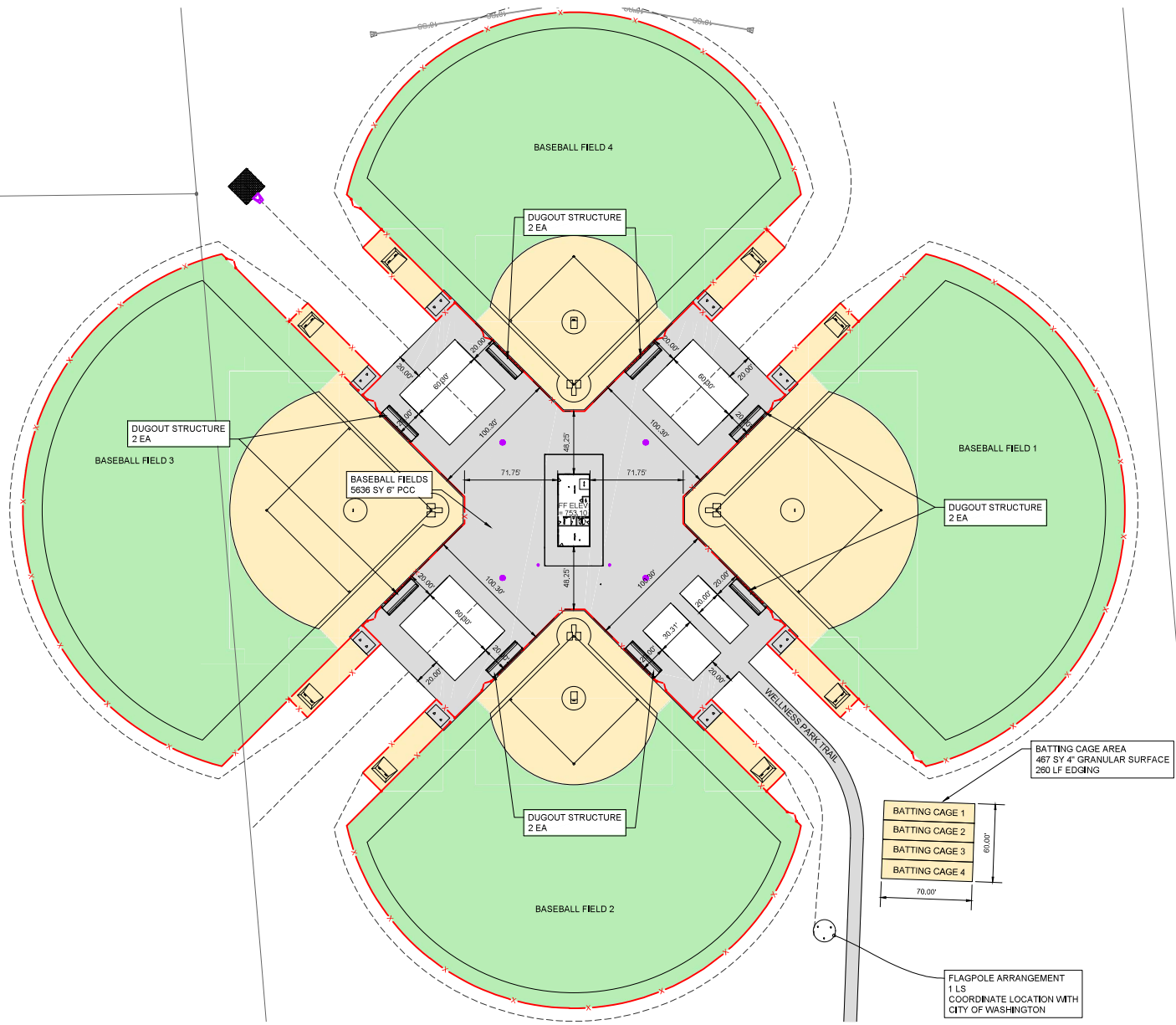

PROJECT DATE	DRAWN BY	NO.	DATE	REVISION	BY
	JLS	-	-	-	-
	JLS	-	-	-	-
	JRH	-	-	-	-

MSA
 ENGINEERING | ARCHITECTURE | SURVEYING
 FUNDING | PLANNING | ENVIRONMENTAL
 400 Ice Harbor Drive, Dubuque IA 52001
 (563) 582-3973 www.msa-ps.com
© MSA International Services, Inc.

BALL FIELDS AND ROADWAY
 CITY OF WASHINGTON
 WASHINGTON, IOWA

SITE PLAN - BASEBALL FIELDS

PROJECT NO.
10322002
 SHEET
S2

PLOT DATE: Friday, March 6, 2020 11:00:55 AM P:\10322002\10322002\CADD\Construction Drawings\27th Street & E Avenue\GITE PLAN - BASEBALL FIELDS.dwg

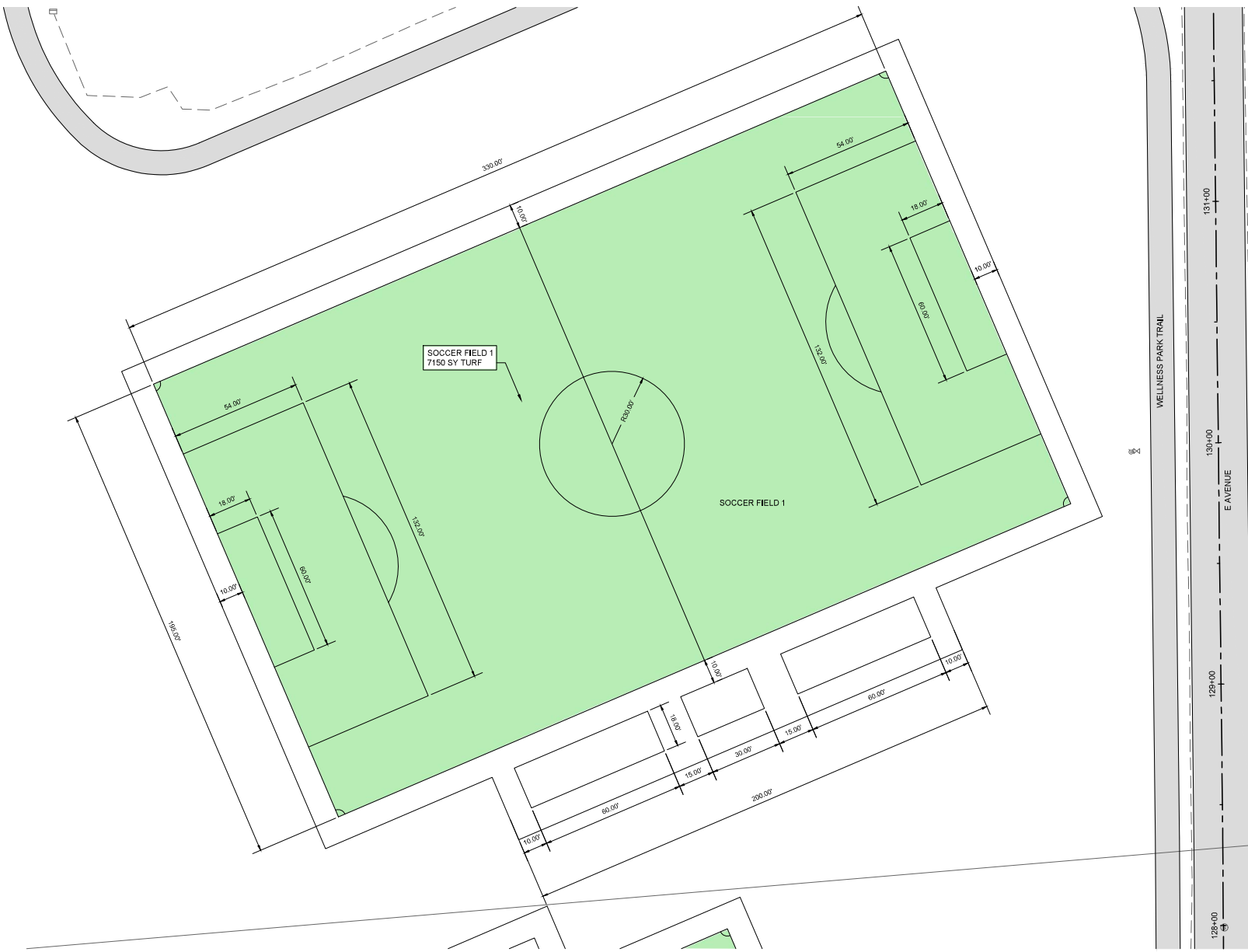

SOCCER FIELD 1
7150 SY TURF

SOCCER FIELD 1

WELLNESS PARK TRAIL

E AVENUE

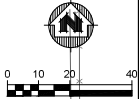

PROJECT DATE	DRAWN BY	NO.	DATE	REVISION	BY
	JLS	-	-	-	-
	JLS	-	-	-	-
	JRH	-	-	-	-



BALL FIELDS AND ROADWAY
CITY OF WASHINGTON
WASHINGTON, IOWA

SITE PLAN - SOCCER FIELD 1

PROJECT NO.
10322002
SHEET
S8

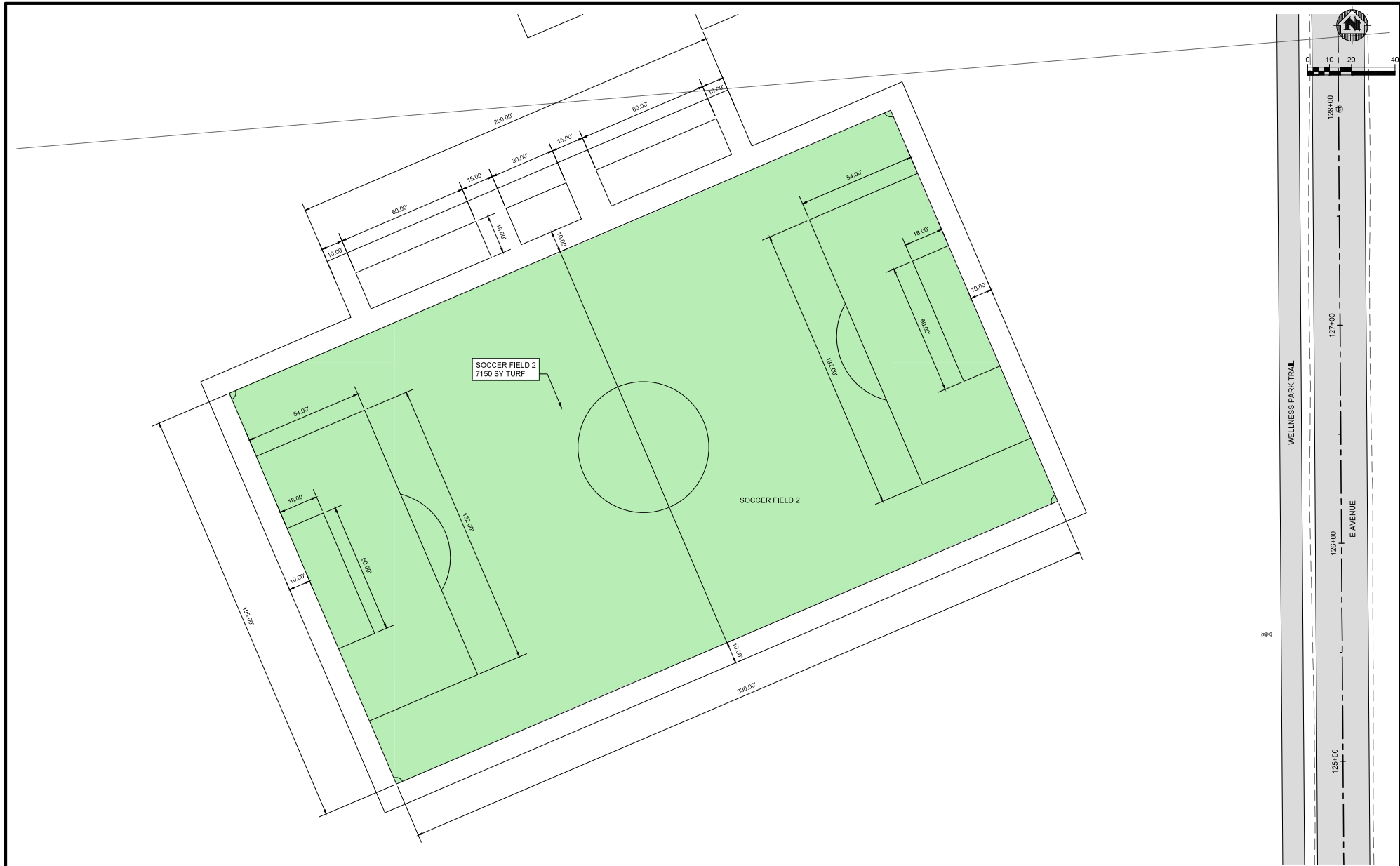

PROJECT DATE	DRAWN BY	NO.	DATE	REVISION	BY
	JLS	-	-		-
	JLS	-	-		-
	JRH	-	-		-

MSA
 ENGINEERING | ARCHITECTURE | SURVEYING
 FUNDING | PLANNING | ENVIRONMENTAL
 400 Ice Harbor Drive, Dubuque IA 52001
 (563) 582-3973 www.msa-ps.com
© MSA International Services, Inc.

BALL FIELDS AND ROADWAY
 CITY OF WASHINGTON
 WASHINGTON, IOWA

SITE PLAN - SOCCER FIELD 2

PROJECT NO.
10322002
 SHEET
59